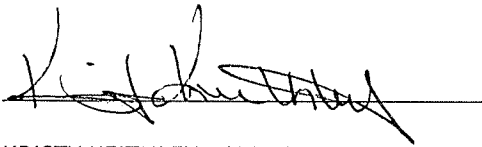

NOTICE OF PLANNING & ZONING MEETING

PUBLIC NOTICE IS HEREBY GIVEN THAT A PLANNING AND ZONING BOARD WILL BE CONDUCTING A REGULAR MEETING TO BE HELD ON THURSDAY SEPTEMBER 24, 2020, 2020 AT 6:30 PM AT THE CLEVER CITY HALL, CLEVER, MISSOURI.

1. Call to Order
2. Pledge of Allegiance
3. Minutes of July 23, 2020
4. Ferguson – Lot Split
5. Willard Construction Plans

DATED THIS 23rd day of September 2020

A handwritten signature in black ink, appearing to read "Kristy Keithley", is written over a horizontal line.

KRISTY KEITHLEY - CITY CLERK

Regular meeting was called to order at 6:30 pm. Pledge of Allegiance.

Present: President Keith, Todd LeBrell, Mayor Maisel, Alderman Hackworth, Ed Westerman and Jaredd King. Garrett Schmidt - absent Refer to sign in sheet for all others present.

Westerman made the motion to approve the minutes of June 25, 2020. Lebrell 2nd the motion and motion passed.

King made the motion to approve the site plans and updated street plans. Lebrell 2nd the motion and motion passed.

Todd Lebrell informed the Commission that he would be resigning his position with the Commission due to the fact he is moving outside the City of Clever. This is a verbal resignation and stated that he has enjoyed his time serving his community.

Westerman made the motion to adjourn at 6:45pm. 2nd by Lebrell and motion passed.

Respectfully Submitted,

Kristy Keithley – City Clerk

Date Approved:

Brandon Keith – Commission President

SHAFFER & HINES, INC.

PROFESSIONAL ENGINEERS & LAND SURVEYORS

P.O. Box 493, Nixa, Missouri 65714

Phone (417) 725-4663

Fax (417) 725-5230

"Equal Opportunity Employer"

July 29, 2020

Ms. Dale Maisel, Mayor
CITY OF CLEVER
P.O. Box 52
Clever, Missouri 65631

**RE: REPLAT OF LOT 1, BLOCK 2 OF HAYES AND HODGES ADDITION
TO THE TOWN OF CLEVER, CHRISTIAN COUNTY, MO**

Dear Mayor:

Our firm has looked over the replat prepared for the above referenced development. Please note the following general comments:

1. The required rear setback for the proposed zoning is 25 feet.

Please contact me should you have questions or require additional information.

Sincerely;

SHAFFER & HINES, INC.
CONSULTING ENGINEERS

Gary W. Shaffer, P.E.

c: Ms. Kristy Keithley, City Clerk

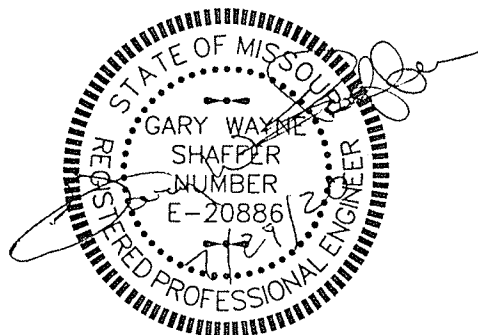

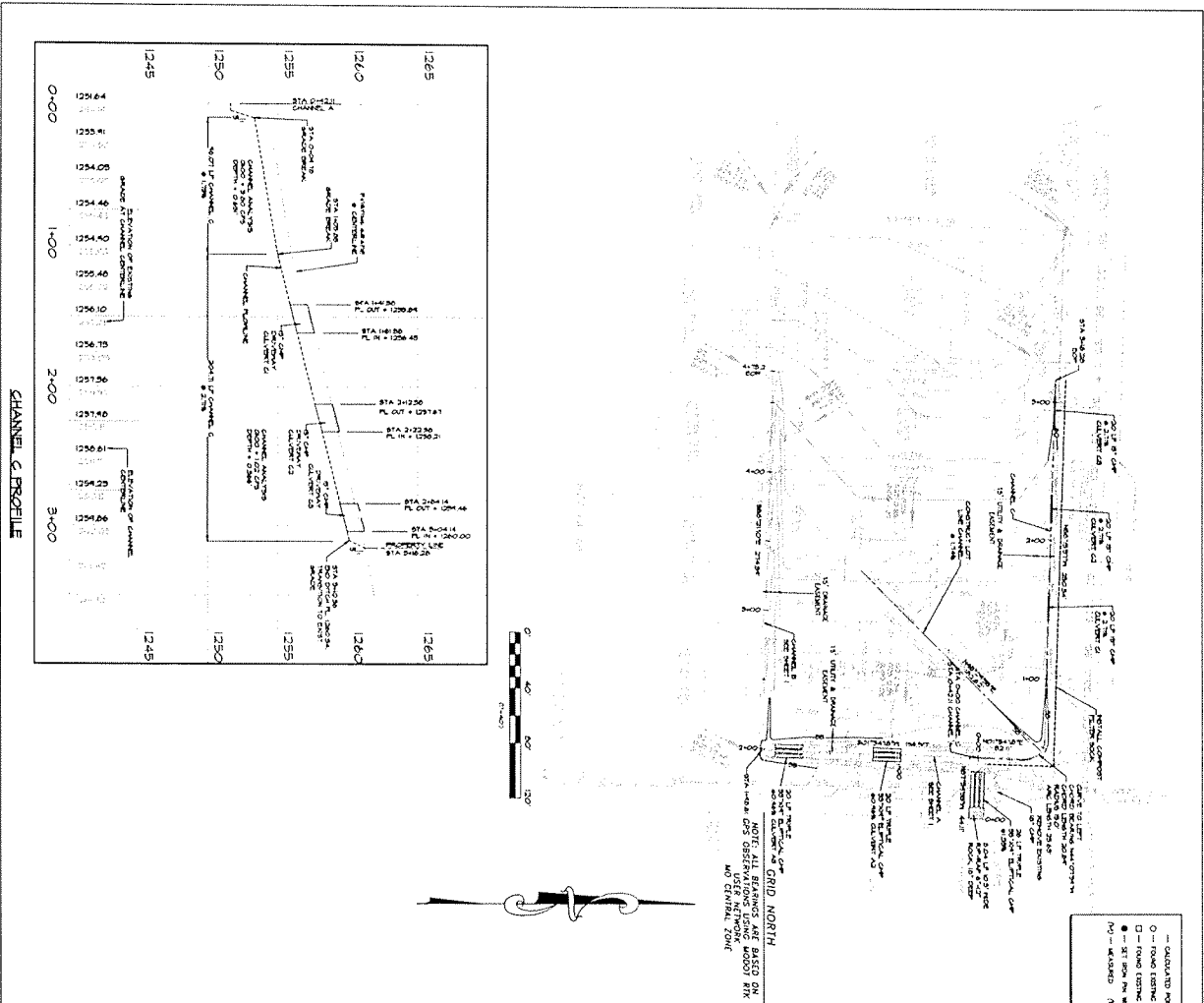

LEGEND

— CALCULATED POINT
 □ ROAD ELEVATION FROM PLAN
 ○ ROAD ELEVATION FROM WATER
 □ ROAD ELEVATION FROM PLAN
 □ ROAD ELEVATION FROM WATER
 □ ROAD ELEVATION FROM PLAN
 □ ROAD ELEVATION FROM WATER

NOTE: ALL BEARINGS ARE BASED ON
 THE 1983 NAD 83 DATUM
 AND CENTRAL ZONE

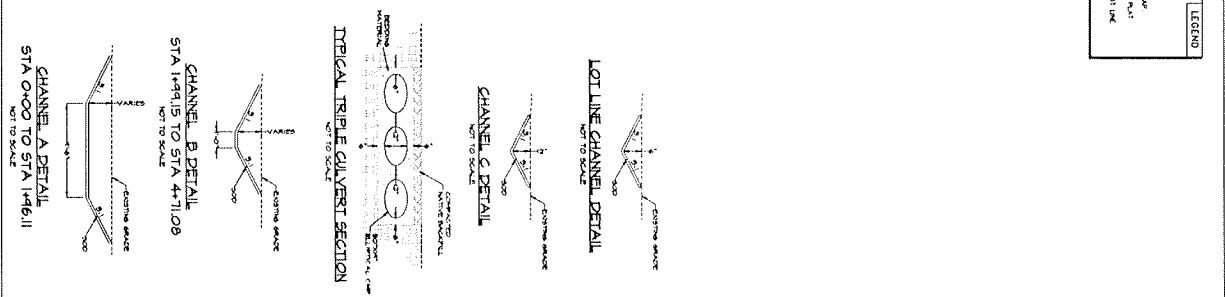

CHANNEL C PROFILE

STATIONING: 0+00 to 3+00

ELEVATIONS: 1245 to 1265

LEGEND

— CALCULATED POINT
 □ ROAD ELEVATION FROM PLAN
 ○ ROAD ELEVATION FROM WATER

CHANNEL A DETAIL
 STA 0+00 TO STA 1+61.11

CHANNEL B DETAIL
 STA 1+61.11 TO STA 4+71.06

CHANNEL C DETAIL

TYPICAL TRIPLE CULVERT SECTION

LOT LINE CHANNEL DETAIL

CHANNEL C DETAIL

CHANNEL B DETAIL

CHANNEL A DETAIL

TYPICAL ELEVATIONS

PLAN

SECTION

CONCRETE FILTER SOCK DETAIL

PLAN

SECTION

CONCRETE FILTER SOCK DETAIL

SANDS CHECK DAM DETAIL

Vandersluis Engineering Inc.
 5000 N. W. 10th St.
 Ft. Lauderdale, FL 33309
 Phone: (954) 576-1111
 Fax: (954) 576-1112
 Website: www.vandersluis.com

CLEVER MISSOURI
 MILLARD ADDITION
 SITE GRADING PLAN
 CHANNEL C PLAN AND PROFILE
 STA 0+00 TO STA 3+16.28